



GreenUp Round Highbay

BY518P LED300/NW PSU WB GM

Lens

The GreenUp Round Highbay range of luminaires provides the optimal balance between basic performance and price. The family covers a wide product range with a variety of options, competitive specifications and long-term quality and reliability. The range is suitable for most industrial applications.

Product data

| General information | |
|---|--------------------|
| Lamp colour code | 840 neutral white |
| Optical cover/lens type | Lens |
| Control interface | - |
| Protection class IEC | Safety class I (I) |
| CE mark | CE mark |
| Number of products on MCB (16 A type B) | 6 |
| Light source engine type | LED |

| Operating and electrical | |
|--------------------------|-------------|
| Input Voltage | 220-240 V |
| Input frequency | 50 or 60 Hz |
| Inrush current | 0.88 A |
| Power factor (min.) | 0.95 |

| Controls and dimming | |
|----------------------|----|
| Dimmable | No |

| Mechanical and housing | |
|-------------------------------------|---------------------|
| Housing material | Aluminium |
| Optical cover/lens material | Polycarbonate |
| Optical cover/lens finish | Matte |
| Overall height | 99 mm |
| Overall diameter | 416 mm |
| Effective projected area | 0.06 m ² |
| Colour | Grey |
| Dimensions (height x width x depth) | 99 x NaN x NaN mm |

| Approval and application | |
|------------------------------|--|
| Ingress protection code | IP65 [Dust penetration-protected, jet-proof] |
| Mech. impact protection code | IK06 [1 J] |

| Initial performance (IEC compliant) | |
|-------------------------------------|----------|
| Initial luminous flux (system flux) | 30000 lm |
| Luminous flux tolerance | +/-10% |
| Initial LED luminaire efficacy | 143 lm/W |

GreenUp Round Highbay

| | |
|-----------------------------|-----------------------|
| Lamp colour temperature | 4000 K |
| Colour Rendering Index | >80 |
| Initial chromaticity | (0.385, 0.380) SDCM<5 |
| Initial input power | 207 W |
| Power consumption tolerance | +/-10% |

Application conditions

| | |
|---------------------------|---------------|
| Ambient temperature range | -20 to +45 °C |
|---------------------------|---------------|

Product data

| | |
|-------------------|-----------------|
| Full product code | 871951453658699 |
|-------------------|-----------------|

| | |
|-----------------------------------|----------------------------|
| Order product name | BY518P LED300/NW PSU WB GM |
| EAN/UPC – product | 8719514536586 |
| Order code | 911401648007 |
| SAP numerator – quantity per pack | 1 |
| Numerator – packs per outer box | 2 |
| SAP material | 911401648007 |
| Net Weight (Piece) | 3.690 kg |



Dimensional drawing

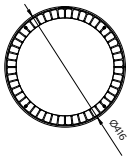

BY518P LED300/NW PSU WB GM

